

Weather Protected Isolating Switches

Introduction:

The IP66 Weatherprotected Isolating Switches is a robust range of switches suitable for virtually any external application.

Included in the range are 1,2, 3 and 4 pole switches from 20 to 80 Amps. And the colour include white and grey. The base mounted mechanism provides for easier termination and more wiring room. Switch dimensions are 165mm x 82mm with an overall height of 85mm.

Fixed Earth and Neutral connector bars with dual clamping screws per tunnel provide equal stripping lengths and secure clamping for all cables. Terminal bore size is 5 x 6.6mm.

A safety feature for mounting switches to metal structures is the insulating caps that cover base mounting screws to totally protect them from any live cables.

Dual 25mm screwed conduit entries top and bottom (up to 55 amp.) allows four ways to surface wire the switch. 55 amp. and above are also available with 32mm entries top and bottom.

Operating Instruction:

1. Cables looped in and out from overhead.
2. In and out from underground.
3. In and out straight through the switch.
4. Two 25mm rear knockouts are moulded in the base for surface mounting with concealed wiring.

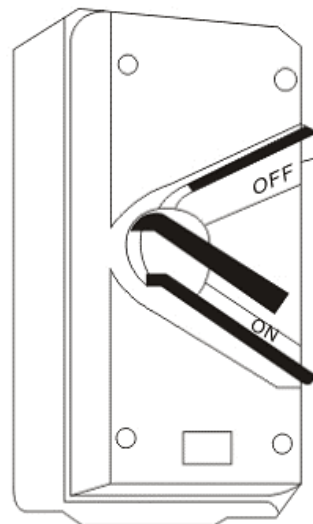
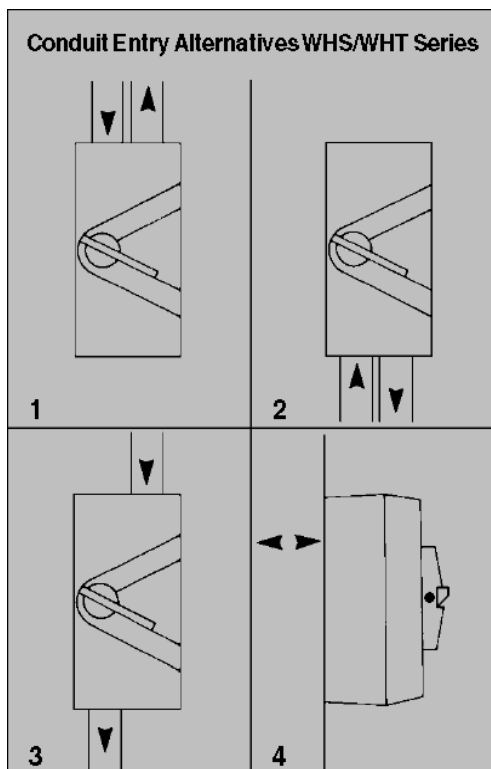

Part No.	Pole	20A	35A	63A
NSACxx-xxx	1	1P-20A	1P-35A	1P-63A
NSACxx-xxx	2	2P-20A	2P-35A	2P-35A
NSACxx-xxx	3	3P-20A	3P-35A	3P-63A
NSACxx-xxx	4	4P-20A	4P-35A	4P-35A